

Unit: mm

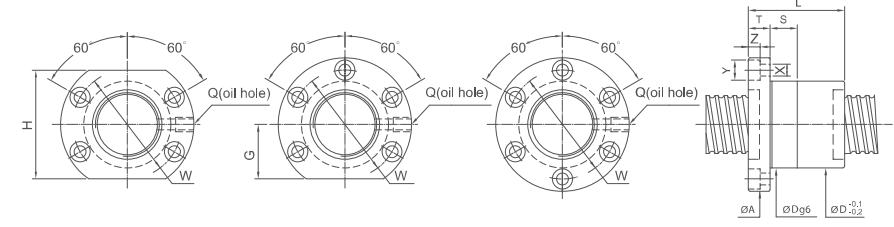

Unit: mm

SCREW SIZE		BALL DIA.	EFFECTIVE TURNS	BASIC RATE LOAD (kgf)		NUT		FLANGE						FIT			BOLT			OIL HOLE	STIFFNESS kgf/mm
O.D.	LEAD			Dynamic (1×10 <sup>6</sup> REV.) Ca	Static Co	Dg6	L	A	T	W	G	H	S	X	Y	Z	Q				
45	8	4.762	4	2870	8620	64	72	92	16	75	36	72	15	9	14.5	9	M6×1P	54			
	12	7.144	3	4160	10750	70	86	110	16	90	42	84	20	11	17.5	11	PT1/8"	48			
			4	5330	14330	70	99	110	16	90	42	84	20	11	17.5	11	PT1/8"	62			
16	6.35	3	3220	8200	70	102	110	16	90	42	84	20	11	17.5	11	PT1/8"	45				
50	5	3.175	4	1730	6760	55	55	61	98	16	82	36	72	20	9	14	8.5	PT1/8"	60		
			5	2100	8450	66	61	98	16	82	36	72	20	9	14	8.5	PT1/8"	74			
			6	2450	10140	65	65	98	16	82	36	72	20	9	14	8.5	PT1/8"	86			
	6	3.969	4	2380	8250	65	65	64	98	16	82	36	72	20	9	14	8.5	PT1/8"	61		
			5	2880	10310	66	64	98	16	82	36	72	20	9	14	8.5	PT1/8"	76			
			6	3370	12380	77	77	98	16	82	36	72	20	9	14	8.5	PT1/8"	90			
	8	4.762	4	3010	9610	79	79	84	113	18	90	42	84	20	11	17.5	11	PT1/8"	63		
			5	3650	12010	70	84	113	18	90	42	84	20	11	17.5	11	PT1/8"	77			
			6	4260	14420	96	96	113	18	90	42	84	20	11	17.5	11	PT1/8"	92			
	10	6.35	3	3430	9300	83	83	93	116	18	94	42	84	20	11	17.5	11	M8×1P	49		
			4	4390	12400	74	93	116	18	94	42	84	20	11	17.5	11	M8×1P	65			
			5	5320	15500	99	99	116	18	94	42	84	20	11	17.5	11	M8×1P	80			
12	7.144	4	5520	16330	104	104	121	22	97	47	94	20	14	20	13	PT1/8"	67				
		5	6690	20410	75	117	121	22	97	47	94	20	14	20	13	PT1/8"	84				
		3	4510	11150	75	99	121	22	97	47	94	20	14	20	13	PT1/8"	50				
16	6.35	3	5770	14870	111	111	121	22	97	47	94	20	14	20	13	PT1/8"	60				
		4	3430	9300	74	104	116	18	94	42	84	20	11	17.5	11	PT1/8"	49				
20	7.938	3	4510	11150	78	146	121	28	97	47	94	20	14	20	13	PT1/8"	50				

SCREW SIZE		BALL DIA.	EFFECTIVE TURNS	BASIC RATE LOAD (kgf)		NUT		FLANGE						FIT			BOLT			OIL HOLE	STIFFNESS kgf/mm
O.D.	LEAD			Dynamic (1×10 <sup>6</sup> REV.) Ca	Static Co	Dg6	L	A	T	W	G	H	S	X	Y	Z	Q				
63	6	3.969	4	2610	10550	80	67	122	18	100	45	90	20	11	17.5	11	PT1/8"	73			
			6	3700	15830	80	80	124	18	102	46	92	20	11	17.5	11	PT1/8"	107			
	8	4.762	4	3375	12200	82	80	124	18	102	46	92	20	11	17.5	11	PT1/8"	76			
			6	4780	18300	82	96	124	18	102	46	92	20	11	17.5	11	PT1/8"	111			
	10	6.35	4	5020	16450	85	98	132	22	107	48	96	20	14	20	13	PT1/8"	79			
			6	7110	24680	85	118	132	22	107	48	96	20	14	20	13	PT1/8"	116			
12	7.938	4	6580	19430	90	111	136	22	112	52	104	20	14	20	13	PT1/8"	80				
		6	9320	29150	90	136	136	22	112	52	104	20	14	20	13	PT1/8"	111				
20	9.525	3	8490	23610	95	146	153	28	123	59	118	20	18	26	17.5	PT1/8"	79				
		4	10870	31480	95	156	153	28	123	59	118	20	18	26	17.5	PT1/8"	89				
80	10	6.35	4	5510	21200	98	98	105	105	151	22	127	57	114	20	14	20	13	PT1/8"	95	
			5	6670	26500	105	105	151	22	127	57	114	20	14	20	13	PT1/8"	118			
	12	7.938	4	7500	25700	110	111	156	22	132	59	118	20	14	20	13	PT1/8"	98			
			6	10620	38550	110	136	156	22	132	59	118	20	14	20	13	PT1/8"	143			
20	9.525	3	9770	31700	115	146	173	28	143	66	132	20	18	26	17.5	PT1/8"	97				
		4	12510	42270	115	168	173	28	143	66	132	20	18	26	17.5	PT1/8"	127				
100	10	6.35	3	4760	20090	84	84	171	22	147	67	134	25	14	20	13	PT1/8"	91			
			4	6090	26790	125	95	171	22	147	67	134	25	14	20	13	PT1/8"	120			
			5	7380	33490	125	104	171	22	147	67	134	25	14	20	13	PT1/8"	148			
	16	9.525	4	8630	40190	115	115	171	22	147	67	134	25	14	20	13	PT1/8"	176			
			5	14440	54960	140	140	171	22	147	67	134	25	14	20	13	PT1/8"	140			
			6	17490	68700	135	157	205	28	169	73	146	30	18	26	17.5	PT1/8"	173			
20	9.525	4	20460	82440	175	175	175	28	169	73	146	30	18	26	17.5	PT1/8"	205				
		5	14440	54960	159	159	175	28	169	73	146	30	18	26	17.5	PT1/8"	140				
20	9.525	4	14440	54960	159	159	175	28	169	73	146	30	18	26	17.5	PT1/8"	173				
		5	17490	68700	135	180	205	28	169	73	146	30	18	26	17.5	PT1/8"	205				

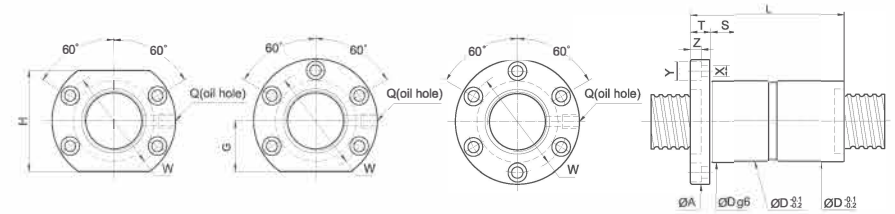
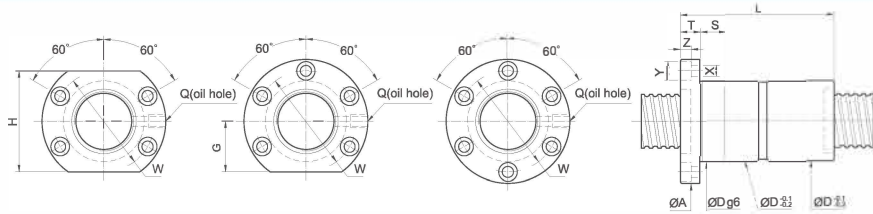

Unit: mm

Unit: mm

SCREW SIZE		BALL DIA.	EFFECTIVE TURNS	BASIC RATE LOAD (kgf)		NUT		FLANGE					FIT				BOLT	OIL HOLE	STIFFNESS kgf/mm
O.D.	LEAD			Dynamic (1x10 <sup>6</sup> REV.) Ca	Static Co	Dg6	L	A	T	W	G	H	S	X	Y	Z			
16	4	2.381	3	435	920	30	66	48.5	10	39	20	40	10	4.5	8	4.5	M6x1P	31	
	5	3.175	4	765	1240	30	89	49	10	39	20	40	10	4.5	8	4.5	M6x1P	35	
20	5	3.175	3	860	1710	34	82	57	12	45	20	40	12	5.5	9.5	5.5	M6x1P	43	
	6	3.969	4	1100	2280	34	92	57	12	45	20	40	12	5.5	9.5	5.5	M6x1P	56	
25	5	3.175	3	980	2300	40	82	63.5	12	51	22	44	15	5.5	9.5	5.5	M8x1P	51	
	6	3.969	4	1250	3070	40	92	63.5	12	51	22	44	15	5.5	9.5	5.5	M8x1P	67	
32	6	3.969	3	1275	2740	40	93	63.5	12	51	22	44	15	5.5	9.5	5.5	M8x1P	52	
	10	4.762	4	1630	3650	40	107	63.5	12	51	22	44	15	5.5	9.5	5.5	M8x1P	68	
36	5	3.175	3	980	2300	40	82	68.5	15	55	26	52	15	6.6	11	6.5	M8x1P	53	
	6	3.969	4	1270	3070	40	92	68.5	15	55	26	52	15	6.6	11	6.5	M8x1P	70	
40	5	3.175	3	1095	3060	48	82	73.5	12	60	30	60	15	6.6	11	6.5	M8x1P	63	
	6	3.969	4	1400	4080	48	92	73.5	12	60	30	60	15	6.6	11	6.5	M8x1P	82	
45	5	3.175	3	1500	3750	54	93	73.5	12	60	30	60	15	6.6	11	6.5	M8x1P	65	
	6	3.969	4	1920	5000	54	107	73.5	12	60	30	60	15	6.6	11	6.5	M8x1P	86	
50	5	3.175	3	1820	4230	50	117	83	16	66	32	64	15	6.6	11	6.5	M8x1P	66	
	6	3.969	4	2330	5640	50	135	83	16	66	32	64	15	6.6	11	6.5	M8x1P	86	
55	5	3.175	3	2605	5310	54	139	88.5	16	70	34	68	15	9	14	8.5	M8x1P	67	
	6	3.969	4	3340	7080	54	160	88.5	16	70	34	68	15	9	14	8.5	M8x1P	89	
60	5	3.175	3	2605	5310	54	153	88	16	70	34	68	15	9	14	8.5	M8x1P	67	
	6	3.969	4	4040	8850	54	203	88	16	70	34	68	15	9	14	8.5	M8x1P	110	
65	5	3.175	4	1490	4690	52	96	88	16	70	34	68	15	9	14	8.5	M8x1P	91	
	8	4.762	4	2530	6630	55	138	88	16	72	34	68	15	9	14	8.5	M8x1P	95	
70	5	3.175	3	2810	6210	58	138	98	18	77	36	72	20	11	17.5	11	M8x1P	75	
	6	3.969	4	3600	8280	58	159	98	18	77	36	72	20	11	17.5	11	M8x1P	98	

SCREW SIZE		BALL DIA.	EFFECTIVE TURNS	BASIC RATE LOAD (kgf)		NUT		FLANGE					FIT				BOLT	OIL HOLE	STIFFNESS kgf/mm
O.D.	LEAD			Dynamic (1x10 <sup>6</sup> REV.) Ca	Static Co	Dg6	L	A	T	W	G	H	S	X	Y	Z			
16	4	2.381	3	1575	5290	30	66	48.5	10	39	20	40	10	4.5	8	4.5	M6x1P	100	
	5	3.175	4	1910	6610	30	89	49	10	39	20	40	10	4.5	8	4.5	M6x1P	124	
20	5	3.175	3	1660	4810	34	82	57	12	45	20	40	12	5.5	9.5	5.5	M6x1P	77	
	6	3.969	4	2130	6410	34	92	57	12	45	20	40	12	5.5	9.5	5.5	M6x1P	103	
25	5	3.175	3	1660	4810	40	82	63.5	12	51	22	44	15	5.5	9.5	5.5	M8x1P	80	
	6	3.969	4	2120	5720	40	92	63.5	12	51	22	44	15	5.5	9.5	5.5	M8x1P	105	
32	6	3.969	3	3010	7100	40	93	63.5	12	51	22	44	15	5.5	9.5	5.5	M8x1P	82	
	10	4.762	4	3850	9470	40	107	63.5	12	51	22	44	15	5.5	9.5	5.5	M8x1P	107	
40	5	3.175	3	3010	7100	48	82	73.5	12	60	30	60	15	6.6	11	6.5	M8x1P	63	
	6	3.969	4	4010	9250	48	92	73.5	12	60	30	60	15	6.6	11	6.5	M8x1P	82	
45	5	3.175	3	4010	9250	54	93	73.5	12	60	30	60	15	6.6	11	6.5	M8x1P	65	
	6	3.969	4	5130	12330	54	107	73.5	12	60	30	60	15	6.6	11	6.5	M8x1P	86	
50	5	3.175	3	4010	9250	50	117	83	16	66	32	64	15	6.6	11	6.5	M8x1P	66	
	6	3.969	4	5130	12330	50	135	83	16	66	32	64	15	6.6	11	6.5	M8x1P	86	
55	5	3.175	3	4010	9250	54	139	88.5	16	70	34	68	15	9	14	8.5	M8x1P	67	
	6	3.969	4	5130	12330	54	160	88.5	16	70	34	68	15	9	14	8.5	M8x1P	89	
60	5	3.175	3	4010	9250	54	153	88	16	70	34	68	15	9	14	8.5	M8x1P	67	
	6	3.969	4	5130	12330	54	203	88	16	70	34	68	15	9	14	8.5	M8x1P	110	
65	5	3.175	4	2870	8620	52	96	88	16	75	36	72	15	9	14.5	9	M6x1P	109	
	8	4.762	4	4160	10750	55	158	88	16	72	34	68	15	9	14	8.5	M8x1P	94	
70	5	3.175	3	4160	10750	58	138	98	18	77	36	72	20	11	17.5	11	PT1/8"	94	
	6	3.969	4	5330	14330	58	183	98	18	77	36	72	20	11	17.5	11	PT1/8"	124	
75	5	3.175	3	3220	8200	70	198	110	16	90	45	90	20	11	17.5	11	PT1/8"	75	
	6	3.969	4	4160	10750	70	233	110	16	90	45	90	20	11	17.5	11	PT1/8"	94	

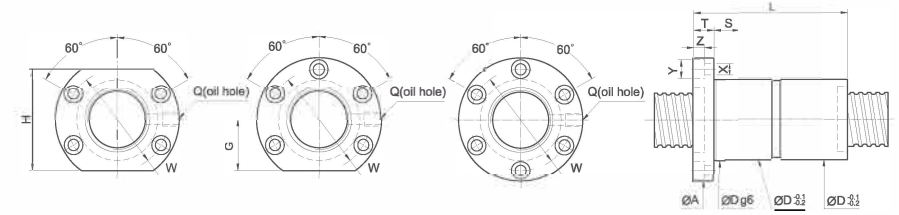
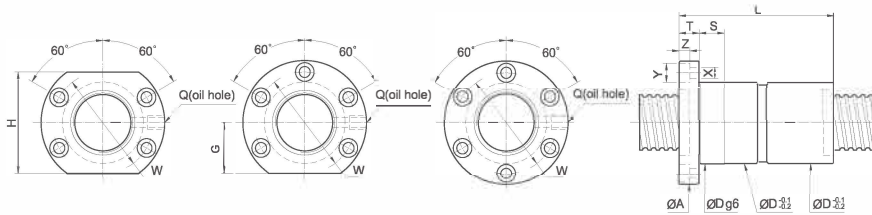

Unit:mm

SCREW SIZE		BALL DIA.	EFFECTIVE TURNS	BASIC RATE LOAD (kgf)		NUT		FLANGE					FIT				BOLT			OIL HOLE	STIFFNESS kgf/mm
O.D.	LEAD			Dynamic (1×10 <sup>6</sup> REV.) Ca	Static Co	Dg6	L	A	T	W	G	H	S	X	Y	Z	Q				
50	5	3.175	4	1730	6760	96													119		
			5	2100	8450	66	111	98	16	82	36	72	20	9	14	8.5	PT1/8"		148		
			6	2450	10140	122														174	
	6	3.969	4	2380	8250	111													123		
			5	2880	10310	66	122	98	16	82	36	72	20	9	14	8.5	PT1/8"		151		
			6	3370	12380	142														181	
	8	4.762	4	3010	9610	136													125		
			5	3650	12010	70	157	113	18	90	42	84	20	11	17.5	11	PT1/8"		155		
			6	4260	14420	174														185	
	10	6.35	3	3430	9300	143													99		
			4	4390	12400	74	162	114	18	92	42	84	20	11	17.5	11	PT1/8"		129		
			5	5320	15500	189														161	
	12	7.938	4	6220	18600	205													191		
			5	6680	20420	75	213	121	22	97	47	94	20	14	20	13	PT1/8"		166		
			6	7770	14870	195														132	
	16	6.35	3	3430	9300	74	201	114	18	92	42	84	20	11	17.5	11	PT1/8"		99		
3			4510	11150	78	253	121	28	97	47	94	20	14	20	13	PT1/8"		101			

Unit:mm

SCREW SIZE		BALL DIA.	EFFECTIVE TURNS	BASIC RATE LOAD (kgf)		NUT		FLANGE					FIT				BOLT			OIL HOLE	STIFFNESS kgf/mm
O.D.	LEAD			Dynamic (1×10 <sup>6</sup> REV.) Ca	Static Co	Dg6	L	A	T	W	G	H	S	X	Y	Z	Q				
63	6	3.969	4	2610	10550	80	120	122	18	100	45	90	20	11	17.5	11	PT1/8"		146		
			6	3700	15830	144													217		
	8	4.762	4	3375	12200	82	141	124	18	102	46	92	20	11	17.5	11	PT1/8"		151		
			6	4780	18300	178													222		
	10	6.35	4	5020	16450	85	166	132	22	107	48	96	20	14	20	13	PT1/8"		158		
			6	7110	24680	209													232		
12	7.938	4	6580	19430	90	195	136	22	112	52	104	20	14	20	13	PT1/8"		161			
		6	9320	29150	248													236			
20	9.525	3	8490	23610	95	255	153	28	123	59	118	20	18	26	17.5	PT1/8"		157			
		4	10870	31480	296													207			
80	10	6.35	4	5510	21200	166												190			
			5	6670	26500	105	185	151	22	127	57	114	20	14	20	13	PT1/8"		235		
			6	7810	31800	209													280		
	12	7.938	4	7500	25700	110	195	156	22	132	59	118	20	14	20	13	PT1/8"		196		
			6	10620	38550	248													288		
	20	9.525	3	9770	31700	254													193		
4			12510	42270	115	297	173	28	143	66	132	20	18	26	17.5	PT1/8"		254			
100	10	6.35	3	4760	20090	143												173			
			4	6090	26790	125	164	171	22	147	67	134	25	14	20	13	PT1/8"		228		
			5	7380	33490	184													281		
	16	9.525	4	8630	40190	210													334		
			4	14440	54960	252													266		
			5	17490	68700	135	285	205	28	169	73	146	30	18	26	17.5	PT1/8"		329		
20	9.525	6	20460	82440	318												391				
		4	14440	54960	299													266			
20	9.525	5	17490	68700	135	340	205	28	169	73	146	30	18	26	17.5	PT1/8"		329			
		6	20460	82440	381													391			

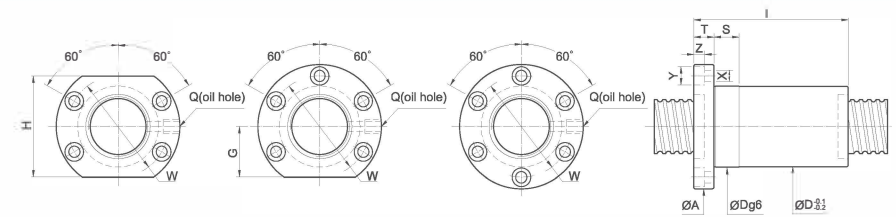
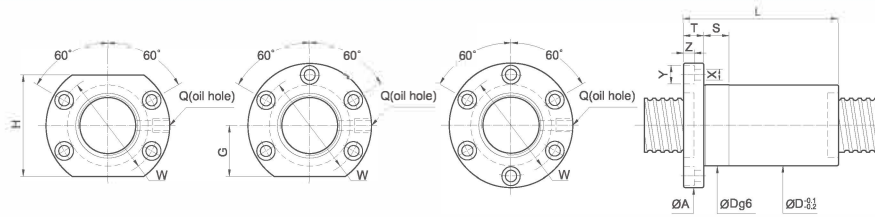

Unit: mm

SCREW SIZE		BALL DIA.	EFFECTIVE TURNS	BASIC RATE LOAD (kgf)		NUT	FLANGE					FIT	BOLT			OIL HOLE	STIFFNESS kgf/mm	
O.D.	LEAD			Dynamic (1x10 <sup>6</sup> REV.) Ca	Static Co		Dg6	L	A	T	W		G	H	S			X
20	5	3.175	2x(2)	610	1140	53											29	
			3x(2)	860	1710	34	67	57	12	45	20	40	12	5.5	9.5	5.5	M6x1P	43
6	3.969	3.175	2x(2)	760	1370	61											29	
			3x(2)	1080	2050	34	77	57	12	45	20	40	12	5.5	9.5	5.5	M6x1P	50
25	4	2.381	2x(2)	350	960	44											30	
			3x(2)	500	1440	40	56	63	12	51	22	44	15	5.5	9.5	5.5	M8x1P	46
	4x(2)	640	1920	64												59		
	2x(2)	690	1530	53												35		
	5	3.175	3x(2)	980	2300	40	67	63.5	12	51	22	44	15	5.5	9.5	5.5	M8x1P	51
			4x(2)	1250	3070	76												67
6	3.969	3x(2)	1275	2740	40	77	63.5	12	51	22	44	15	5.5	9.5	5.5	M8x1P	52	
8	3.969	3x(2)	1275	2740	40	85	63.5	12	51	22	44	15	5.5	9.5	5.5	M8x1P	52	
10	4.762	2x(2)	1140	2140	42	88											36	
		3x(2)	1610	3210	42	102	69	15	55	26	52	15	6.6	11	6.5	M8x1P	53	
28	6	3.175	3x(2)	1030	2630	43	69	68	12	55	26	52	15	6.6	11	6.5	M8x1P	56
			2x(2)	730	1750	45	77	73	12	60	30	60	15	6.6	11	6.5	M8x1P	38
32	4	2.381	3x(2)	560	1840	43	56										55	
			5x(2)	870	3070	43	73	68	12	55	26	52	15	6.6	11	6.5	M8x1P	89
	5	3.175	3x(2)	1095	3060	48	67	73.5	12	60	30	60	15	6.6	11	6.5	M8x1P	63
			4x(2)	1400	4080	48	77											82
	6	3.969	3x(2)	1500	3750	48	77	73.5	12	60	30	60	15	6.6	11	6.5	M8x1P	65
			4x(2)	1920	5000	48	90											86
8	4.762	3x(2)	1820	4230	50	95	83	16	66	32	64	15	6.6	11	6.5	M8x1P	66	
		4x(2)	2330	5640	50	112											86	
10	6.35	3x(2)	2605	5310	54	120	88	16	70	34	68	15	9	14	8.5	M8x1P	67	
12	6.35	3x(2)	2605	5310	54	124	88	16	70	34	68	15	9	14	8.5	M8x1P	67	

Unit: mm

SCREW SIZE		BALL DIA.	EFFECTIVE TURNS	BASIC RATE LOAD (kgf)		NUT	FLANGE					FIT	BOLT			OIL HOLE	STIFFNESS kgf/mm	
O.D.	LEAD			Dynamic (1x10 <sup>6</sup> REV.) Ca	Static Co		Dg6	L	A	T	W		G	H	S			X
40	5	3.175	3x(2)	1230	3970	65											75	
			4x(2)	1575	5290	55	80	88.5	16	72	29	58	15	9	14	8.5	M8x1P	100
	6	3.969	6x(2)	2230	7940	101											147	
			4x(2)	2130	6410	55	93	88.5	16	72	34	68	15	9	14	8.5	M8x1P	103
50	8	4.762	6x(2)	3020	9620	118											149	
			4x(2)	2720	7620	60	116	93	16	76	36	72	20	9	14	8.5	M8x1P	105
	10	6.35	3x(2)	3010	7100	64	123	106	18	84	43	86	20	11	17.5	11	PT1/8"	82
			4x(2)	3850	9470	64	143											107
12	6.35	4x(2)	3850	9470	63	160	106	18	84	43	86	20	11	17.5	11	PT1/8"	107	
		3x(2)	1350	5070	65												89	
63	5	3.175	4x(2)	1730	6760	66	80	98	16	82	36	72	20	9	14	8.5	PT1/8"	119
			6x(2)	2450	10140	101												174
	6	3.969	4x(2)	2380	8250	66	93	98	16	82	36	72	20	9	14	8.5	PT1/8"	123
			6x(2)	3370	12380	66	118											181
	8	4.762	4x(2)	3010	9610	70	119	113	18	90	42	84	20	11	17.5	11	PT1/8"	125
			3x(2)	3430	9300	74	123	116	18	92	42	84	20	11	17.5	11	M8x1P	99
10	6.35	4x(2)	4390	12400	74	143											129	
		7.144	4x(2)	5530	16330	75	164	121	22	97	47	94	20	14	20	13	PT1/8"	135
12	7.938	3x(2)	4510	11150	75	147	121	22	97	47	94	20	14	20	13	PT1/8"	101	
		4x(2)	5770	14870	75	164											132	
80	6	3.969	4x(2)	2610	10550	80	96	122	18	100	45	90	20	11	17.5	11	PT1/8"	146
			6x(2)	3700	15830	80	121											217
	8	4.762	4x(2)	3375	12200	82	119	124	18	102	46	92	20	11	17.5	11	PT1/8"	151
			3x(2)	5140	14570	90	147	136	22	112	52	104	20	14	20	13	PT1/8"	122
	10	6.35	4x(2)	5020	16450	85	147	132	22	107	48	96	20	14	20	13	PT1/8"	158
			4x(2)	6580	19430	90	171											161
20	9.525	2x(2)	5990	15740	95	156	153	28	123	59	118	20	18	26	17.5	PT1/8"	107	
10	6.35	2x(2)	3360	13390	105	95	171	22	147	67	134	25	14	20	13	PT1/8"	118	
		3x(2)	4760	20090	105	115											173	
16	9.525	2x(2)	11280	41220	115	175	205	28	169	73	146	30	18	26	17.5	PT1/8"	201	
20	9.525	3x(2)	7960	27480	115	159	205	28	169	73	146	30	18	26	17.5	PT1/8"	137	



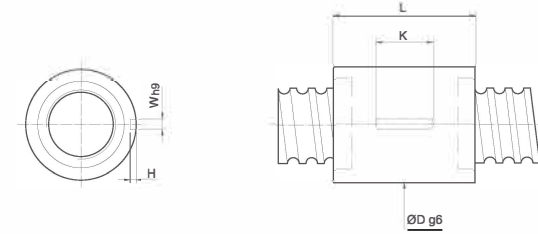
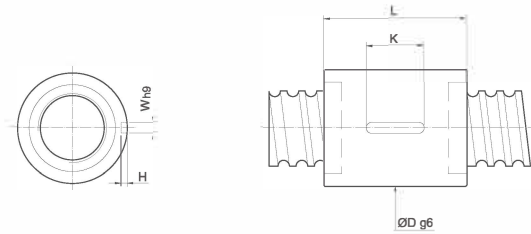

Unit: mm

Unit: mm

SCREW SIZE	O.D.	LEAD	BALL DIA.	EFFECTIVE TURNS	BASIC RATE LOAD (kgf)		NUT		KEYWAY			STIFFNESS kgf/µm
					Dynamic (1×10 <sup>6</sup> REV.) Ca	Static Co	Dg6	L	K	W	H	
16	5	3.175	3	3	765	1240	30	40	20	3	1.8	18
				4	860	1710	34	41	20	3	1.8	21
20	5	3.175	3	860	1710	34	41	20	3	1.8	21	
			4	1100	2280	48	48	20	3	1.8	28	
25	6	3.969	3	1080	2050	34	46	20	4	2.5	22	
			4	1380	2730	56	56	25	4	2.5	28	
32	5	3.175	3	980	2300	40	41	20	4	2.5	26	
			4	1250	3070	40	48	20	4	2.5	33	
40	6	3.969	3	1275	2740	40	46	20	4	2.5	26	
			4	1630	3650	40	56	25	4	2.5	34	
50	5	3.175	3	1095	3060	41	41	20	4	2.5	31	
			4	1400	4080	48	48	20	4	2.5	41	
63	6	3.969	3	1500	3750	46	46	20	5	3.0	32	
			4	1920	5000	50	56	25	5	3.0	43	
80	8	4.762	3	1820	4230	50	59	25	5	3.0	32	
			4	2330	5640	50	70	25	5	3.0	43	
100	10	6.35	3	2605	5310	54	68	25	6	3.5	33	
			4	3340	7080	54	79	32	6	3.5	45	
125	5	3.175	4	1575	5290	55	48	20	4	2.5	49	
			6	2230	7940	55	61	25	4	2.5	73	
160	6	3.969	4	2130	6410	55	56	25	5	3.0	51	
			6	3020	9620	55	70	32	5	3.0	75	
200	8	4.762	4	2720	7620	60	70	25	5	3.0	52	
			6	3850	11430	60	91	40	5	3.0	77	
250	10	6.35	3	3010	7100	65	68	25	6	3.5	41	
			4	3850	9470	65	79	32	6	3.5	53	

SCREW SIZE	O.D.	LEAD	BALL DIA.	EFFECTIVE TURNS	BASIC RATE LOAD (kgf)		NUT		KEYWAY			STIFFNESS kgf/µm
					Dynamic (1×10 <sup>6</sup> REV.) Ca	Static Co	Dg6	L	K	W	H	
32	5	3.175	4	4	1730	6750	66	48	20	4	2.5	60
				6	2450	10130	66	61	25	4	2.5	86
50	6	3.969	4	2380	8250	66	56	25	5	3.0	61	
			6	3370	12380	66	70	32	5	3.0	90	
63	8	4.762	4	3010	9610	70	70	32	5	3.0	63	
			6	4260	14420	70	91	32	5	3.0	92	
80	10	6.35	3	3430	9300	74	68	32	6	3.5	49	
			4	4390	12400	74	79	32	6	3.5	65	
100	12	7.938	3	4510	11150	75	82	40	6	3.5	50	
			4	5770	14870	75	95	40	6	3.5	66	
125	6	3.969	4	2610	10550	80	56	25	6	3.5	73	
			6	3700	15830	80	70	32	6	3.5	107	
160	8	4.762	4	3375	12200	82	70	32	6	3.5	76	
			6	4780	18300	82	91	40	6	3.5	111	
200	10	6.35	4	5020	16450	85	79	32	8	4.0	79	
			6	7110	24680	85	85	40	8	4.0	116	
250	12	7.938	4	6580	19430	90	95	40	8	4.0	80	
			6	9320	29150	90	123	50	8	4.0	118	
320	10	6.35	4	5510	21200	105	79	32	8	4.0	95	
			6	7810	31800	105	102	40	8	4.0	140	
400	12	7.938	4	7500	25700	110	95	40	8	4.0	98	
			6	10620	38550	110	123	50	8	4.0	143	
500	20	9.525	3	9770	31700	115	126	50	10	5.0	97	
			4	12510	42270	115	149	63	10	5.0	127	
630	10	6.35	3	4760	20090	125	72	50	10	5	91	
			4	6090	26790	125	82	50	10	5	120	
800	16	9.525	4	7380	33490	135	94	63	10	5	148	
			6	8630	40190	135	104	75	10	5	176	
1000	20	9.525	4	14440	54960	144	128	75	10	5	140	
			5	17490	68700	135	77	63	10	5	173	
1250	20	9.525	6	20460	82440	162	162	75	10	5	205	
			4	14440	54960	144	144	75	10	5	140	
1600	20	9.525	5	17490	68700	135	164	63	10	5	173	
			6	20460	82440	162	187	75	10	5	205	

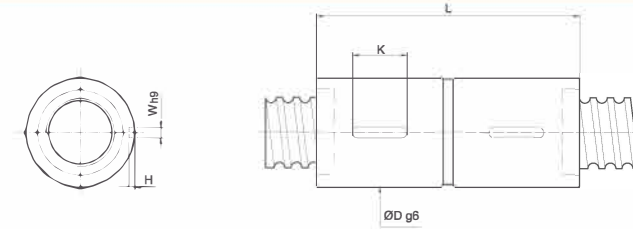
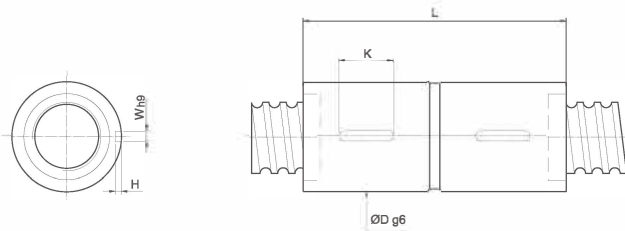

Unit: mm

SCREW SIZE		BALL DIA.	EFFECTIVE TURNS	BASIC RATE LOAD (kgf)		NUT		KEYWAY			STIFFNESS
O.D.	LEAD			Dynamic (1x10 <sup>6</sup> REV.) Ca	Static Co	Dg6	L	K	W	H	kgf/mm
16	5	3.175	3	765	1240	28	75	20	3	1.8	35
			4	980	1650	85					47
20	5	3.175	3	860	1710	34	75	20	3	1.8	43
			4	1100	2280	85					56
25	6	3.969	3	1080	2050	34	87	20	4	2.5	43
			4	1380	2730	103	25				56
25	5	3.175	3	980	2300	40	75	20	4	2.5	51
			4	1250	3070	85					67
32	6	3.969	3	1275	2740	40	87	20	4	2.5	52
			4	1630	3650	103	25				68
32	5	3.175	3	1095	3060		75	20			63
			4	1400	4080	48	85	20	4	2.5	82
32	6	3.969	6	1980	6120		105	25			122
			3	1500	3750		87	20			65
40	8	4.762	4	1920	5000	50	103	25	5	3.0	86
			6	2720	7500		127	32			125
40	10	6.35	3	1820	4230	50	109	25	5	3.0	66
			4	2330	5640	127					86
40	5	3.175	3	2605	5310		135	25	6	3.5	67
			4	3340	7080	54	155	32			89
40	6	3.969	4	1575	5290	55	85	20	4	2.5	100
			6	2230	7940		105	25			147
40	8	4.762	4	2130	6410	55	103	25	5	3.0	103
			6	3020	9620		127	32			149
40	10	6.35	4	2720	7620	60	127	25	5	3.0	105
			6	3850	11430		161	40			154
40	3	3.175	3	3010	7100	65	135	25	6	3.5	82
			4	3850	9470		155	32			107

Unit: mm

SCREW SIZE		BALL DIA.	EFFECTIVE TURNS	BASIC RATE LOAD (kgf)		NUT		KEYWAY			STIFFNESS
O.D.	LEAD			Dynamic (1x10 <sup>6</sup> REV.) Ca	Static Co	Dg6	L	K	W	H	kgf/mm
50	5	3.175	4	1730	6750	66	85	20	4	2.5	119
			6	2450	10130		105	25			174
50	6	3.969	4	2380	8250	66	103	25	5	3.0	123
			6	3370	12380		127	32			181
50	8	4.762	4	3010	9610	70	127	32	5	3.0	125
			6	4260	14420		161				185
50	10	6.35	3	3430	9300		135	32			99
			4	4390	12400	74	155	32	6	3.5	129
50	12	7.938	6	6220	18600		197	40			191
			3	4510	11150	75	161	40	6	3.5	101
50	4	3.175	4	5770	14870		185				132
			6	2610	10550	80	106	25	6	3.5	146
50	8	4.762	6	3700	15830		130	32			217
			4	3375	12200	82	131	32	6	3.5	151
50	10	6.35	6	4780	18300		165	40	6	3.5	222
			4	5020	16450	85	160	32	8	4.0	158
50	12	7.938	6	7110	24680		202	40			232
			4	6580	19430	90	185	40	8	4.0	161
50	6	3.175	6	9320	29150		238	50	8	4.0	236
			4	5510	21200	105	160	32	8	4.0	190
50	8	4.762	6	7810	31800		202	40			280
			4	7500	25700	110	185	40	8	4.0	196
50	10	6.35	6	10620	38550		238	50			288
			4	9770	31700	115	245	50	10	5.0	193
50	12	7.938	4	12510	42270		289	63			254
			3	4760	20090		132				173
50	4	3.175	4	6090	26790	125	164	50	10	5	228
			6	7380	33490		174				281
50	6	3.969	6	8630	40190		204				334
			4	14440	54960		240				266
50	16	9.525	5	17490	68700	135	274	63	10	5	329
			6	20460	82440		306				391
50	4	3.175	4	14440	54960		284				266
			5	17490	68700	135	324	63	10	5	329
50	6	3.969	6	20460	82440		366				391
			4	14440	54960		284				266
50	20	15.875	5	17490	68700	135	324	63	10	5	329
			6	20460	82440		366				391